

**PROPOSED SITE PLAN LAYOUT**

PROJECT. PROPOSED CONSTRUCTION OF  
AQOON BILE PRIMARY SCHOOL  
IN KISMAYO

IMPLEMENTING AGENCY



IOM International Organization for Migration

SCALE	
DATE	APRIL 2017
DESIGNED BY:	W. DAVID
DRAWN BY:	W. DAVID
REVIEWED BY:	
APPROVED BY:	

DRAWING TITLE:

DRAWING N°:

PROJECT N°:

<b>DRAWINGS</b>
SHEET N°:

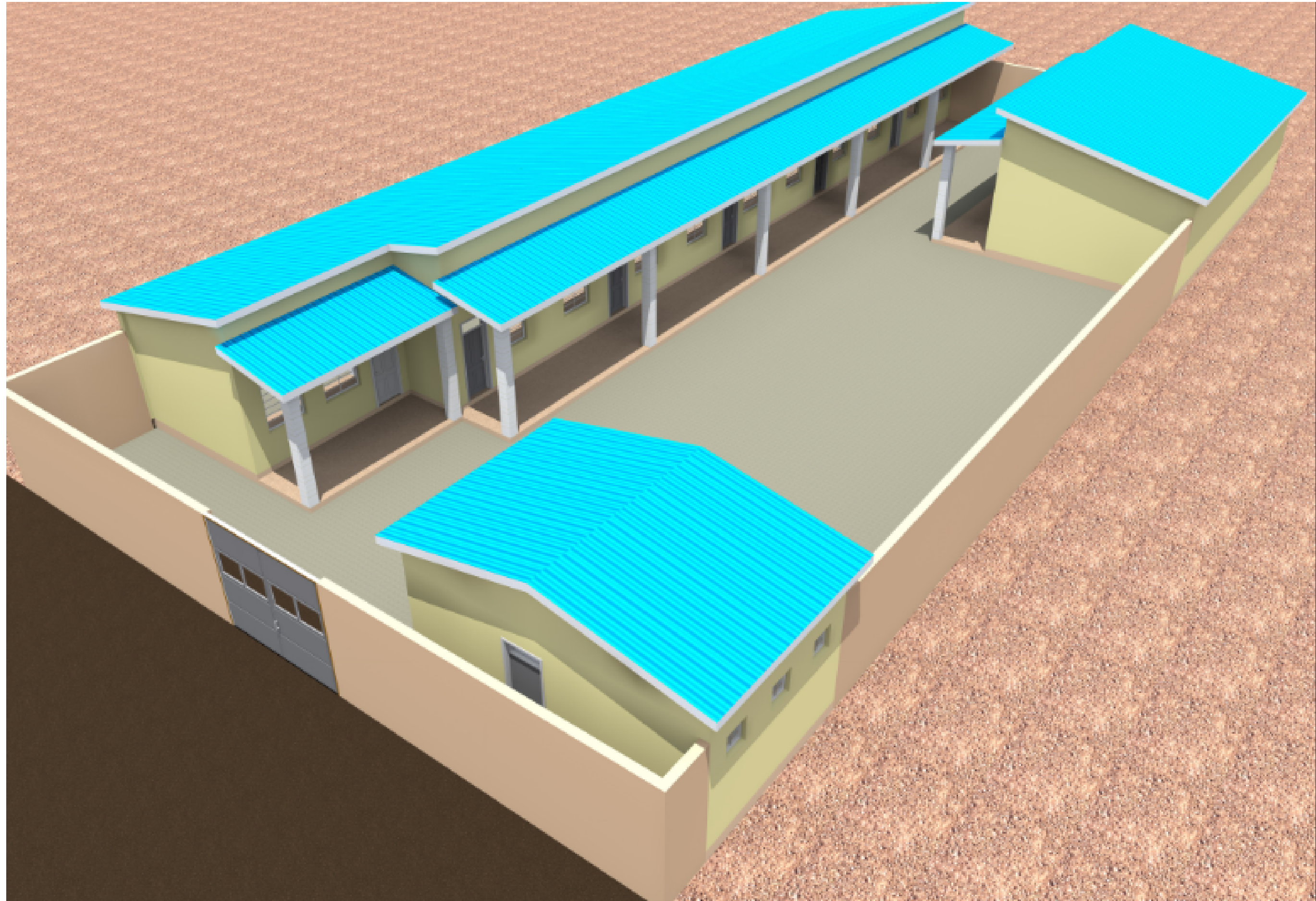

**PROPOSED SCHOOL OVERVIEW**

PROJECT. PROPOSED CONSTRUCTION OF  
AQOON BILE PRIMARY SCHOOL  
IN KISMAYO

IMPLEMENTING AGENCY



IOM International Organization for Migration

SCALE		DRAWING TITLE:
DATE	APRIL 2017	DRAWING N°:
DESIGNED BY:	W. DAVID	PROJECT N°:
DRAWN BY:	W. DAVID	
REVIEWED BY:		
APPROVED BY:		

<b>DRAWINGS</b>
SHEET N°:

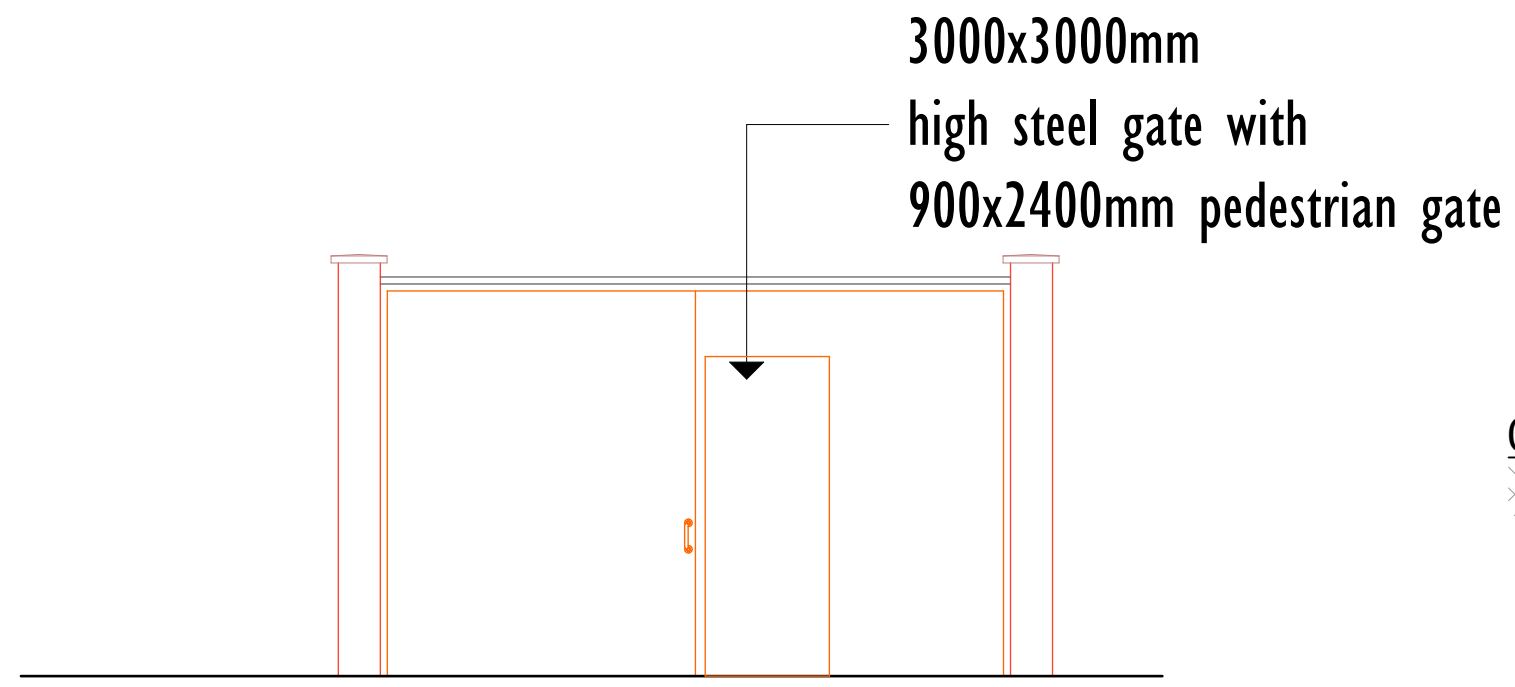

**ACCESS GATE**

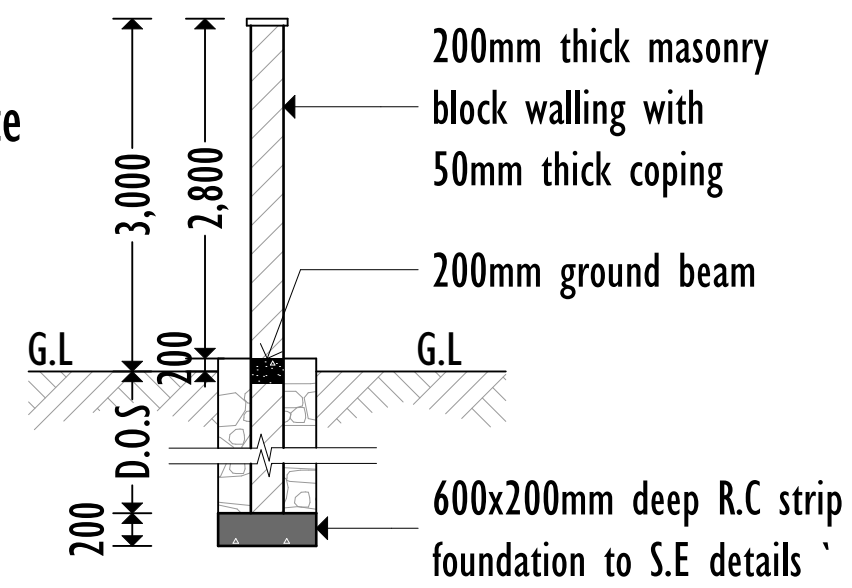

**TYPICAL SECTION**

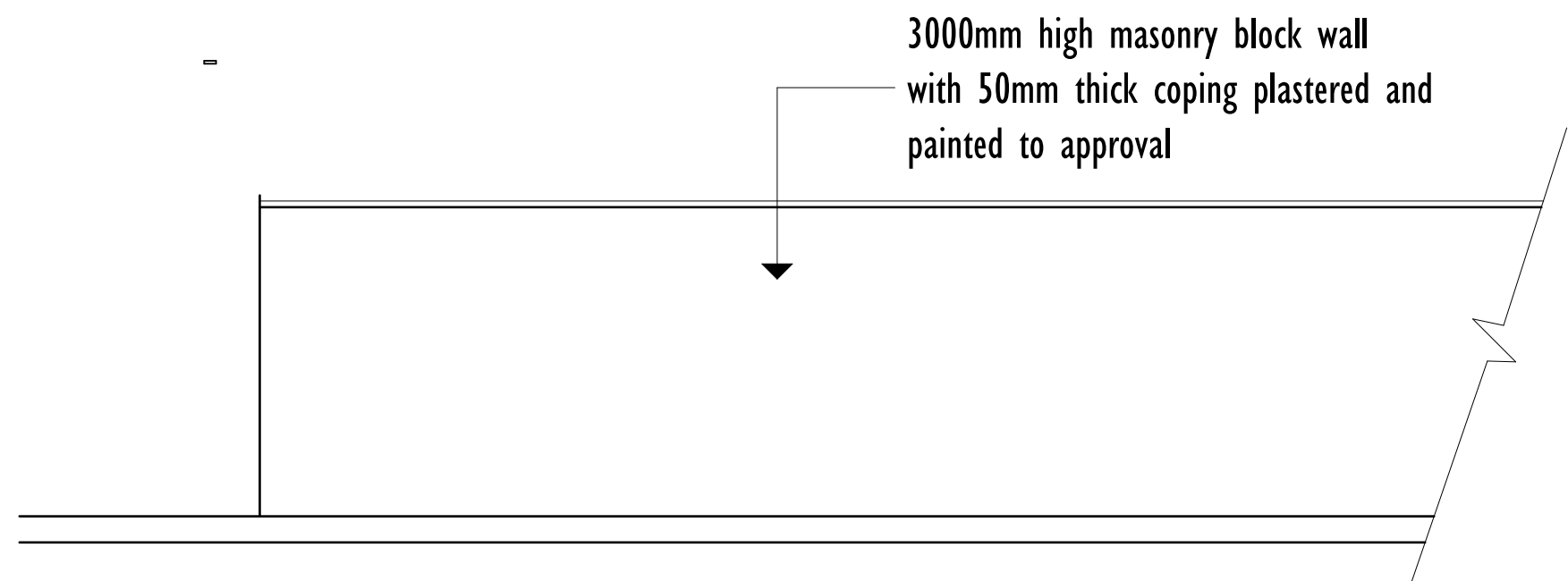

**BOUNDARY WALL - ELEVATION**

PROJECT. PROPOSED CONSTRUCTION OF  
AQOON BILE PRIMARY SCHOOL  
IN KISMAYO

IMPLEMENTING AGENCY  
  
 IOM International Organization for Migration

SCALE	
DATE	APRIL 2017
DESIGNED BY:	W. DAVID
DRAWN BY:	W. DAVID
REVIEWED BY:	
APPROVED BY:	

DRAWING TITLE:	
DRAWING N <sup>o</sup> :	
PROJECT N <sup>o</sup> :	

**DRAWINGS**

SHEET N<sup>o</sup>: